

MILD STEEL SCREWED PIPE FITTINGS

BS EN 10241

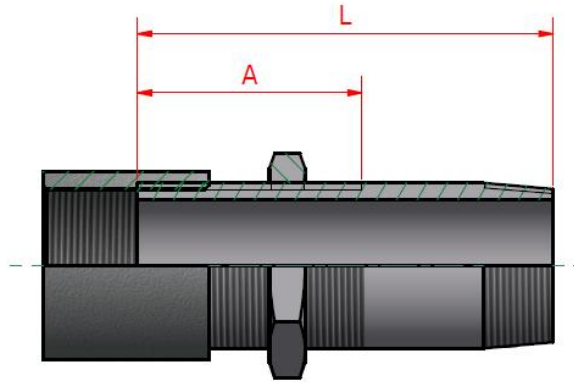

Thread 1 is BSP taper to ISO 7.1 Thread 2 is BSP parallel to ISO 7.1

Longscrew



Nominal bore		Minimum useful length of parallel thread dim. A	Typical overall lengths supplied dim. L				Average weight each including socket & nut
Metric	Imperial		mm	mm	mm	mm	
6mm	1/8"	29	75	100	125	150	0.06
8mm	1/4"	37	75	100	125	150	0.12
10mm	3/8"	40	100	150	200	250	0.18
15mm	1/2"	52	100	150	200	250	0.27
20mm	3/4"	54	100	150	200	250	0.36
25mm	1"	62	100	150	200	250	0.51
32mm	1 1/4"	70	150	200	250	300	0.83
40mm	1 1/2"	71	150	200	250	300	1.08
50mm	2"	82	150	200	250	300	1.44
65mm	2 1/2"	97	150	200	250	300	2.54
80mm	3"	106	200	250	300	400	3.24
100mm	4"	121	200	250	300	400	5.57
125mm	5"	130	250	300	400	500	7.97
150mm	6"	132	250	300	400	500	9.44

To ensure the correct fit we recommend that longscrews should be bought as complete assemblies. If matching separate components the parallel thread must be produced using a backnut as a gauge.