

BSP taper thread ISO 7.1

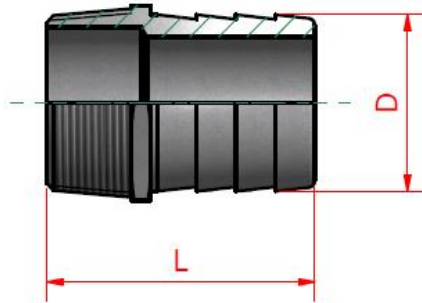

**Hose tail**



Nominal bore		Diameter dim. D	Length dim. L	Weight each
Metric	Imperial	mm	mm	kgs
6mm	1/8"	7	35.5	0.02
8mm	1/4"	9	40.0	0.03
10mm	3/8"	11	42.5	0.03
15mm	1/2"	13	52.5	0.06
20mm	3/4"	20	57.2	0.09
25mm	1"	25	64.5	0.15
32mm	1 1/4"	33	71.0	0.22
40mm	1 1/2"	39	74.5	0.29
50mm	2"	51	85.0	0.48
65mm	2 1/2"	65	94.5	0.74
80mm	3"	77.5	123.5	1.05
100mm	4"	103	128.0	1.85